



User Manual A11 EN
Please read the manual before use

1 EN Table of contents

Product description	2
Parts name	3
Introduction for wireless mode	4
How to charge the battery	4
How to apply the needle cartridge	5
Adjustment of needle length	6
Speed display and adjustment	6
How to use the inductive base	7
Needle cartridge introduction	8
Reference chart	9
Specification	9
Precaution	10
Warranty	11

2 EN Product description

The device consists of an electric microneedling pen, an inductive base and disposable needle cartridges. This manual will explain how to use each component in detail.

The device is used to improve the appearance of the skin and reduce signs of aging. It is intended to stimulate the skin with micro-needles for collagen and elastin production. The microchannels are created in the superficial skin by the device also help with the absorption of skin serums.

There are 7 different types of needle cartridges designed for the device. These cartridges can be used for micro-needling treatment and nano-needling treatment.

3 EN Parts name



- ① Power Interface
- ② Speed Display
- ③ Speed adjustment
- ④ Power button Start/Pause button
- ⑤ Inductive base
- ⑥ Scale Point
- ⑦ Scale Adjustment Ring
- ⑧ Needle Cartridge

4 EN Introduction for wireless mode

This device is powered by a built-in battery. It can work wirelessly. The power cable and the adapter are used to charge the device when it is out of battery.

How to charge the battery

Connect the power cable with adapter to the power interface of device and plug the adapter into a live AC outlet to charge the device. Charging will complete in about 3 hours.

The number of speed flashes slowly when the battery is capacity 10% left .

The pen will turn off automatically after the number of speed flashes quickly for 1 minute.

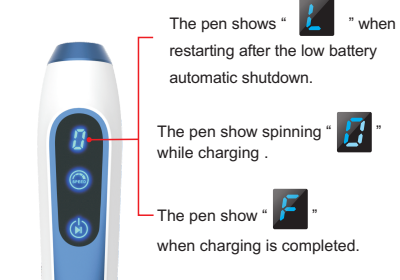

5 EN How to apply the needle cartridge

1. Take out needle cartridge from the sterilized packaging. [Fig1]

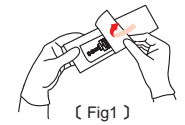

2. Find the "U" shape notch on the cartridge, align the notch with the dot on the bottom of the device, and slightly push the cartridge into the device. [Fig2]

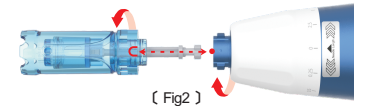

3. Lock the needle cartridge to the device by turning it clockwise.
4. Turn the needle cartridge counterclockwise and pull it out when you would like to remove the cartridge.
5. Start the device only when the needle cartridge is assembled correctly. Press and hold the power button for 3 seconds to turn on/off the device.

Before assembling or disassembling the needle cartridge, make sure the U-shaped point of the needle cartridge is aligned with the point of the handpiece.

The needle cartridge is designed for single use.
Place the used needle cartridges in a trash container. If the needle cartridge is inadvertently contaminated during installation (i.e. Dropped on the floor, package opened/damaged.), please discard it and get a new needle cartridge.

6 EN Adjustment of needle length

Use suitable needle size according to different treatment areas and skin problems

Adjust the depth of the needle by turning the scale adjustment ring. The depth of the needle should be adjusted after starting the pen. The scale number aligning with the scale point shows the current needle depth. [Fig3]

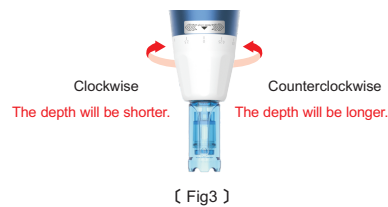

Speed display and adjustment

Speed Display



6 Speeds Adjustment

Press and hold the power button for 3 seconds to start or shut down the device. After starting the device, the speed changes once every time the power button is pressed.

7 EN How to use the inductive base

After the device is turned on. Short press the power button to start or pause the device.

Running state:
The light of power button is constant on.
Waiting state:
The light of power button flashes continuously.

In the running state, the device will automatically stop working when it stays on the inductive base.



In the running state, the device will automatically restart working after leaving the inductive base.



8 EN Needle cartridge introduction

Available needle cartridges

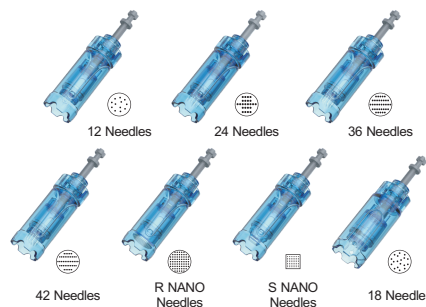

Attention

The needle cartridge is disposable.

The needle cartridge is designed for Dr.pen A11 only.

Please sterilize the needle cartridge with 75% alcohol for a few minutes before use.

Please dispose the used needle cartridge to the trash container.



9 EN Reference chart

REGION	NEEDLE DEPTH (mm)
Forehead	0.25 - 0.5
Between the Eyebrows	0.25 - 0.5
Nose	0.25
Around the orbital rim	0.25
Cheek and Chin	0.5 - 1.0
Surgical and Scar Maximum	2.5

Specification

Product name :
Auto-stamp Motorized Meso Machine
Model name : Dr.pen A11
Adapter
Input : 100-240V 50-60HZ Output : 5V \equiv 1A
Package Weight : 625 g
Package Size : 194*146*67 mm

Packing List

Item	Quantity
Hand Piece	1 pc
Adapter	1 pc
Manual	1 pc
Power Cable	1 pc
Needle Cartridge	2 pcs
Base inductive	1 pc

10 EN Precaution

- Please be sure to read the instructions before use and follow as described.
- Do not apply it to the person as following:**
1. Who has acute disease or bloody disease over 38°C
2. Who has allergy and hemophilia
3. Who has melanosis of the face
4. Who has high internal heat
5. Who regularly visits hospital
6. Who takes medicines
7. Who is under 12 years old
- Do not use it on the power other than AC 220V. It may cause fires or malfunction.
- Do not use it near the place with high temperature, dust or humidity (Near the humidifier). It may cause malfunction.
- Do not repair, disassemble or alter the controller and the body. It may cause malfunction.
- Do not touch the device or detach the power cords with wet hands. It may cause electric shock.
- Do not use the stripped cord or propped cord. It may cause fires(Be sure to replace it with another).
- Do not use the propped cord which has crack or scars. It may cause scares on the skin.
- When you don't use it for a long time, unplug it from the outlet.
- Be sure to have an inspection for test. If any troubles are found, get it repaired.
- No one other than the operator can touch it. It may cause accidents or malfunction.
- Alternating current [SN] Serial No
- Direct current [Manufacturer logo] Manufacturer
- Date of manufacture [CE mark] CE mark
- Attention, consult accompanying documents [i] Consult instruction for use

11 EN Warranty

The warranty period of the device is 12 months. We offer repair service from the purchase date. If any of our products has damages or natural trouble, we provide replacements or repair service. The use of third-party cartridges can cause damage to the device. This could invalidate the warranty.

General maintenance

Make sure to inspect the device and adapter before use.

Ensure the device is turned off when not in use. Wipe its surface with a disinfecting wipe.

Pay attention to clean areas such as crevices, seams, and areas around where the needle cartridge attaches to the device.

Keep it away from direct sunlight or high temperature or humidity.

Do not leave the measurement, repair or alter of the device to non-professional staffs.

When you use the device which has not been used for a long time, make sure to check if it works properly with safety.